



User Guide P2



Follow the official account
and register for a DPVR account.

www.dpvr.com

Images in the manual are for reference only.
Please refer to the actual product.

Product Packing List

Main Device: DPVR VR All-in-One VR Headset

Accessories Charger
USB Cable
User Manual & Warranty Certificate
Controllers
3A Batteries

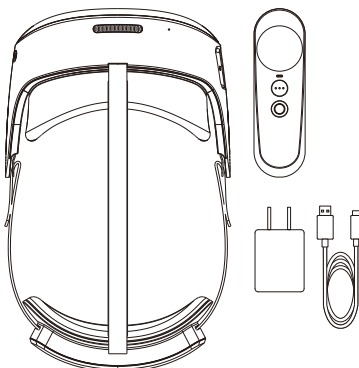

-1-

Buttons / Ports / Indicator Light States

Microphone

Head Strap

Optical Lenses

Optical Sensor
Distance Sensor

Touchpad

Indicator
Light

Menu
Button

TYPE-C Port

Power Button

Volume
Buttons
Micro
phone
Back
Button

Speaker

Headphone Jack

TF Card Slot

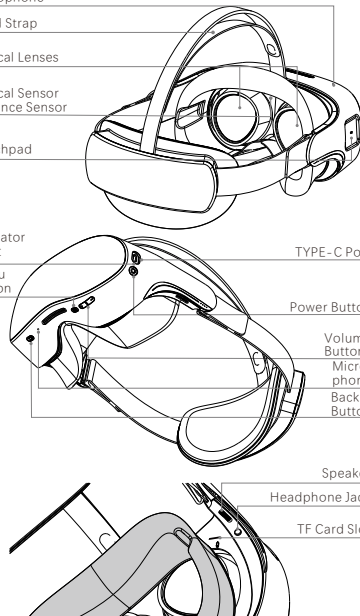

-2-

Button Description

| | | |
|----------------|--|--|
| Power Button | | Short Press: Turns off the screen to sleep/wake Long Press (3 seconds): Turns the device on/off Long Press (10 seconds): Force shuts down the device |
| Back Button | | Short Press: Returns to the previous step |
| Menu Button | | Short Press: Home function Long Press (3 seconds): Adjusts the viewing angle Double Press: Enters quick settings |
| Volume Buttons | | Adjusts the volume level |
| Touchpad | | Swipe: Page turning function Tap: Confirms actions |

Ports Descriptions

| | |
|----------------|--|
| Audio Port | For connecting wired headphones |
| Micro USB Port | For charging and data transfer |
| TF Card Slot | Located under the mask, insert the TF card as shown in the diagram after removing the mask |

Indicator Light States Descriptions

| | |
|--------------------|--|
| Blue Light On | Device is in normal working condition |
| Green Light On | Charging is complete |
| Red Light On | Battery is low |
| Red Light Blinking | Voltage is low; after charging for a certain duration, the device can be turned on |
| Yellow Light On | Charging in progress |

-3-

Head Strap Installation Adjustment Instructions

Installing and Adjusting the Head Strap

1. The top head strap can be adjusted to three positions. Choose the position that is comfortable and secures the headset.
- *2. The connection cable between the headset and the battery contains cables that are necessary for the headset to function properly. Avoid bending, pulling, or damaging these cables.

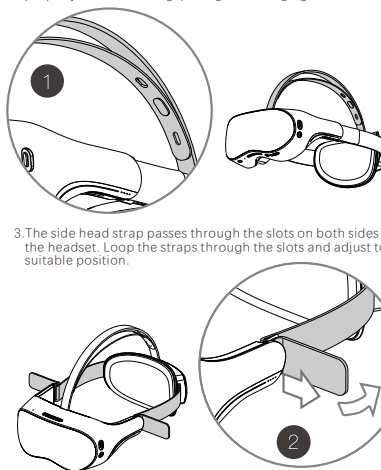

-4-

IPD Adjustment Instructions

The device supports three levels of IPD adjustment (58mm / 64mm / 70mm). You can manually move the lenses to the left or right to adjust to the appropriate pupil distance.

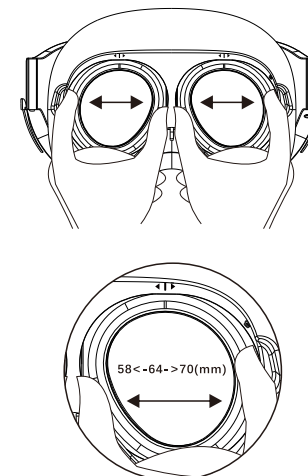

Note: Using an inappropriate pupil distance setting may cause double imaging or eye fatigue.

-5-

Battery Removal Instructions

The rear battery is designed to be removable. Push the release button on the side of the battery cover to remove the battery. *If needed, you can purchase additional batteries and a battery charger as required.

For more details, you can visit the relevant website.

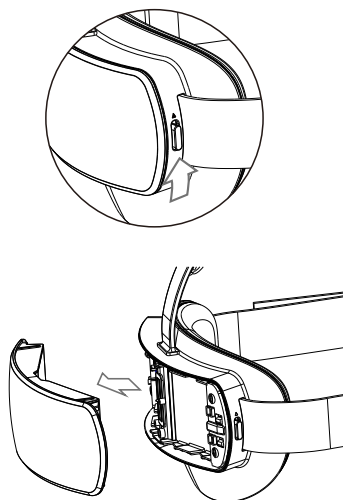

-6-

Touchpad Instructions

Tap Operation

1. Turn your head to align the cursor on the screen with the menu you want to select.
2. Use your finger to tap the touchpad.

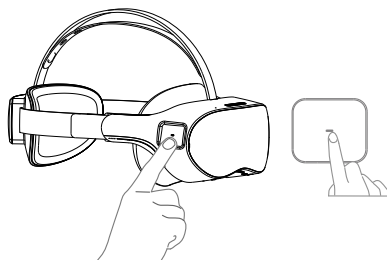

Swipe left or right for page turning.

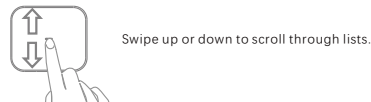

Swipe up or down to scroll through lists.

-7-

Cursor Positioning Instructions

The device can recognize head movements and use them to position the cursor within the screen display area.

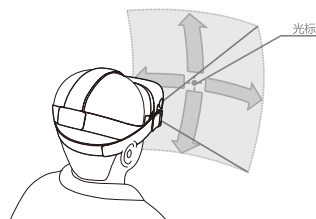

Cursor Selection

By turning your head and tapping the touchpad, you can select applications and options.

1. Turn your head to move the cursor to the desired area.
2. Tap the touchpad (on the right side of the device).

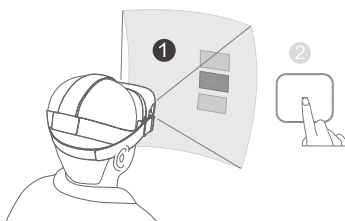

-8-

Controller Usage Instructions

1.Product Overview

| | |
|----------------|---------------------------|
| Product Name: | DPVR Bluetooth Controller |
| Product Model: | BC301 |
| Weight: | 45g |
| Dimensions: | 12mm x 37mm x 34mm |
| Connection: | Bluetooth |
| Battery: | 2 x AAA |

2.Button Definitions

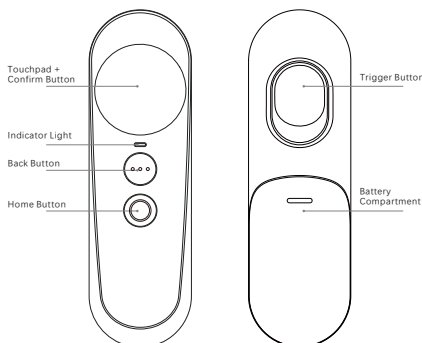

-9-

3.Button Usage Instructions

| | | |
|----------------|--|---|
| Home Button | | Short Press: Return to the main interface. Long Press (2 seconds): Reorient the field of view. Long Press (5 seconds): Power on/off the Bluetooth controller. |
| Back Button | | Short Press: Go back to the previous menu. |
| Touchpad | | Swipe: Scroll through pages. Tap: Confirm |
| Trigger Button | | Press: Confirm. |

Press: Confirm.

4.Indicator Light Status

| | |
|-----------------------|---|
| Power On, Not Paired: | White light blinking (once per second). |
| Pairing in Progress: | Solid white light. |
| Pairing Completed: | White light turns off. |
| Normal Button Press: | White light illuminates. |
| Low Battery: | Fast blinking (twice per second). |

5.Pairing

- Ensure that the host's Bluetooth function is turned on.
- When the host is in pairing mode, simultaneously press the "Back Button" and "Home Button" on the controller according to the on-screen prompt. The white light will turn off once pairing is successful.
- If pairing is unsuccessful, the white light will blink (once per second).
- If the white light turns off but the target host doesn't show the controller connection, check for interference from other devices nearby. After eliminating the interference, retry pairing.

-10-

Safety Information

Before using the device, please read the following safety information to ensure safe and proper usage.

Follow the warning information provided below to prevent accidents such as fires or explosions.

- Do not subject the device to physical collisions or damage.
- Use only manufacturer-approved chargers and accessories.
- Avoid touching the device with wet hands. Additionally, do not use the device in liquid environments such as bathrooms or during activities like swimming.
- The icon indicates suitability for non-tropical climate conditions only.

Follow the warnings below to prevent harm to people or damage to the device

- Do not store the device in excessively hot or cold places. It is recommended to use the device in an ambient temperature environment between 0°C - 35°C.
- Charging the device in temperatures lower than 0°C or higher than 40°C can potentially damage the battery.
- When not in use, store the device in a cool and dry place. Avoid direct sunlight or strong light sources on the device's lens to prevent screen damage from intense light.
- Keep the device dry and avoid using it outdoors during thunderstorms.
- To prevent potential hearing damage while using headphones, do not use high volume levels for extended periods.
- This device is not recommended for use by individuals under the age of 13. For individuals under 13 years old and those over 65 years old, guardians should restrict usage time to ensure intermittent use and rest periods.

-11-

FCC Warning

This device complies with part 15 of the FCC Rules. Operation is subject to the following two conditions:

(1) This device may not cause harmful interference, and (2) this device must accept any interference received, including interference that may cause undesired operation.

Any Changes or modifications not expressly approved by the party responsible for compliance could void the user's authority to operate the equipment.

Note: This equipment has been tested and found to comply with the limits for a Class B digital device, pursuant to part 15 of the FCC Rules. These limits are designed to provide reasonable protection against harmful interference in a residential installation. This equipment generates uses and can radiate radio frequency energy and, if not installed and used in accordance with the instructions, may cause harmful interference to radio communications. However, there is no guarantee that interference will not occur in a particular installation. If this equipment does cause harmful interference to radio or television reception, which can be determined by turning the equipment off and on, the user is encouraged to try to correct the interference by one or more of the following measures:

- Reorient or relocate the receiving antenna.
- Increase the separation between the equipment and receiver.
- Connect the equipment into an outlet on a circuit different from that to which the receiver is connected.
- Consult the dealer or an experienced radio/TV technician for help.

FCC RF Exposure Information and Statement

The SAR limit of USA (FCC) is 1.6 W/kg averaged over one gram of tissue. Device types: P2 (FCC ID: 2A878-P2) has also been tested against this SAR limit. The highest SAR value reported under this standard during product certification for use properly worn on the body is 0.976W/kg. This device was tested for typical body-worn operations with the back of the handset kept 0mm from the body. To maintain compliance with FCC RF exposure requirements, use accessories that maintain a 0mm separation distance between the user's body and the back of the handset. The use of belt clips, holsters and similar accessories should not contain metallic components in its assembly. The use of accessories that do not satisfy these requirements may not comply with FCC RF exposure requirements, and should be avoided.

Body-worn Operation

This device was tested for typical body-worn operations. To comply with RF exposure requirements, a minimum separation distance of 0mm must be maintained between the user's body and the handset, including the antenna. Third-party belt-clips, holsters, and similar accessories used by this device should not contain any metallic components. Body-worn accessories that do not meet these requirements may not comply with RF exposure requirements and should be avoided. Use only the supplied or an approved antenna.