



## User Manual

# LABEL PRINTER



Model: D2

# Table of Contents

---

<b>Important Safety Instructions .....</b>	<b>01</b>
<b>About the Product .....</b>	<b>04</b>
Overview	
What's Included	
Specification	
<b>Using the Product .....</b>	<b>05</b>
Before Use	
Operation	
<b>Cleaning and Maintenance .....</b>	<b>11</b>
<b>Troubleshooting .....</b>	<b>12</b>
<b>Warranty .....</b>	<b>13</b>
<b>Customer Service .....</b>	<b>14</b>

Thank you for choosing iDOO Label Printer! It's a take-with-you type of label printer that you can carry with you easily and print from anywhere and organizational tool for home offices and small businesses. iDOO accepts no responsibility for any cause of injuries due to misuse or negligence to follow the instructions outlined. Please read all of these instructions and keep for future reference.

## Important Safety Instructions

### **READ ALL INSTRUCTIONS CAREFULLY BEFORE USING.**

When using this device, the following basic precautions should be always followed:

1. This device can be used by children aged 8 years and above and by persons with reduced physical, sensory or cognitive capabilities or lack of experience and knowledge if they have been given supervision or instructions concerning the use of the device in a safe way and understand the hazards involved.
2. Children should not play with the device. Cleaning and user maintenance should not be made by children.

3. Close supervision is necessary when this device is used by, on or near children, invalids, and disabled persons.
4. Use this device only for its intended use as described in this manual.
5. Never operate this device if it is not working properly or has been damaged.
6. Never drop or insert any object into any opening.
7. Do not operate in the areas where aerosol (spray) products are being used or where oxygen is being administered.
8. Do not keep the device near a magnetic field or as it may cause batteries to discharge.
9. Do not use for more than 30 minutes at a time. Excessive use could lead to overheating.
10. Keep the device away from heat, humidity and dust.
11. Avoid direct exposure to sunlight and rain.
12. Do not pull the tape as it could damage the roller and the print head.
13. Ensure the print cover is firmly closed before use.

### **DANGER**

To reduce the risk of electric shock:

1. Do not reach for the device that has fallen into the water.
2. Do not use the device with wet hands.
3. Do not submerge or drop into water or other liquid.

## **About the Battery**

1. **Warning Chemical Exposure:** If the battery pack leaks, do not allow the liquid to contact the skin or eyes. If contact has been made, wash the affected area with copious amounts of water and seek medical advice.
2. Do not throw the battery into the fire or heat the battery. The used battery should be placed in a sealed plastic bag and safely disposed of in accordance with local environmental regulations.
3. Battery life may vary by application and/or operating conditions. If the device is not in use for a long period of time, please keep it powered off and charge it once a month to prolong its lifespan.

**SAVE THESE INSTRUCTIONS.**

# About the Product

## 1. Overview

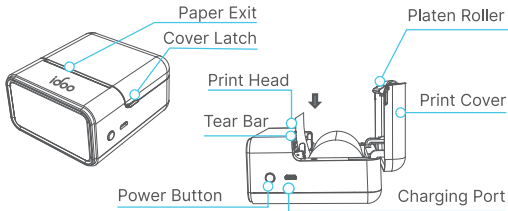

## 2. What's Included



Label Printer x 1



User Manual x 1



Charging Cable x 1



Label Tape x 2(1.97 x 0.79" / 0.55 x 1.18")



Holder

### 3. Specification

Product Name: Label Printer

Model: D2

Input: 5V  2A

Battery Capacity: 1200mAh

Charging Time: about 4H

Operating Time: about 2.5H

Print Method: Direct Thermal

Print Speed: up to 0.6 IPS (15mm/S)

Max. Effective Print Width: 1.89in (48mm)

Max. Print Length: 5.9in (150mm)

Resolution: 203 dpi (8 dots/mm)

Dimension: 3.7 x 3.3 x 1.9in (94×85×48mm)

Product Weight: 0.4lb (180g)

## Using the Product

### 1. Before Use

#### 1.1 Fully charge the device before its first use

Please charge the device using the provided charging

cable and a DC 5V 2A charger (not included). It takes about 4 hours to fully charge the device. The power indicator light will remain solid red during charging and will then turn green once charging is complete.

- \* The device runs on a single charge for about 2.5 hours.

## 1.2 Install the Label Tape

- Lift the cover latches on both sides to open the print cover.

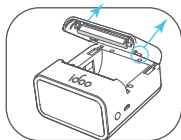

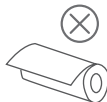

**Install the standard tape:** Gently drop it in the printer and make sure to orient it toward the cover.



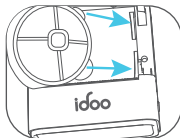
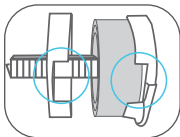

**Install the small tape:** Slide it through the holder and place the holder in the printer, making sure the notches are aligned.



 Avoid touching the surface of the print head with your finger. Acids and oils on your skin will damage the print head.

b. Pull out enough paper over the tear bar, then close the cover.  
Make sure you press down on the cover until it snaps shut.

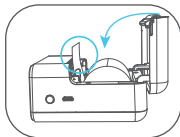

## 2. Operation

### 2.1 Power On/Off



Press and hold the Power button for 2s to turn On/Off the printer.

\* To ensure safety and prolong the service life of the device, it will automatically shut off after 20 minutes of inactivity.

### 2.2 Self Test

Double press the Power button to run a label test. Check whether the printer is functioning normally and the label is positioned correctly.

### 2.3 Indicators

Indicator Status	Description
	Normal operation / Fully charged
	Successfully connected to the App
	Out of paper / Low battery / Overheating / Charging

\* When the indicator light turns red suddenly, please deal with it accordingly and timely.

### 3. Creating a Tag

#### 3.1 Download the App

Scan the QR code or search "Joyprint" to download the App from Apple Store or Google Play.



**Note:** Due to continuous updates and improvements, the App may appear slightly different.

3.2 Tap "create.." to create a new tag, and input the width and height that match the actual label you place in the printer. Make sure not to mix the width and height.

A form for creating a new tag. It has a "template name" field with the value "2023-05-19 18:43:49". Below this is a "quick size" button. Then there are two input fields: "template width" with the value "50 mm" and "template height" with the value "20 mm". At the bottom is a "confirm" button.

Customize the tag by adjusting the font, adding a code and applying icons, then tap “Print Now”, it will go to preview page. Tap “Confirm” after you select the number of copies.



## Cleaning and Maintenance

1. Always turn off the device before cleaning.



Wipe the exterior surface of the device with a soft cloth slightly dampened with non-abrasive cleaners.

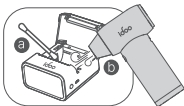

a. Use slightly dampened cotton swabs with alcohol to remove dust on the print head and roller.

b. Or use an air duster to blow the dust away.



Make sure the device is completely dry inside and out before placing a paper roll in it.

2. Store the device in a cool, dry place when not in use.
3. Do not attempt to disassemble or repair the device. The device does not contain user-serviceable parts.
4. Cover up the device when not in use to prevent dust.

# Troubleshooting Guide

Problem	Possible Reason	Solution
The device cannot be turned on.	Incorrect operation.	Long press the Power button for 2s.
	The battery runs out.	Charge the device.
The device shuts off.	The device will automatically shut off after 20 minutes of inactivity.	Restart the device.
	The battery runs out.	Charge the device.
The device is not printing labels.	Out of paper.	Replace with a new roll.
The device is printing blank labels.	The roll label is placed in the opposite direction.	Check the installation instruction on page 6 and install it correctly.
The printed content is not clear.	1. The print head is dirty. 2. Poor quality of label.	1. Clean the print head after powering off the device. 2. Use our original labels.

<b>Problem</b>	<b>Possible Reason</b>	<b>Solution</b>
The content is missing.	The actual <b>label</b> size doesn't match what you set in the App.	Create/select the correct size for the <b>label</b> .
The device cannot connect to the App.	<ol style="list-style-type: none"> <li>1. Bluetooth is not enabled.</li> <li>2. It's been connected to another mobile device.</li> </ol>	<ol style="list-style-type: none"> <li>1. Turn on Bluetooth on your phone.</li> <li>2. Disconnect it first, then try again.</li> </ol>

## Warranty (1-Year Period)

The manufacturer's warranty is void under the following circumstances but not limited to:

- Improper or inadequate maintenance or modification.
- Accident, misuse, abuse, contamination, or other external causes.
- The use of unspecified adapter and accessories.
- Loss or damage in transit.
- Damages that occur as a result of one's failure to follow the instructions.

- This warranty does not apply to expendable or consumable parts and does not extend to any product from which the serial number has been removed.

## Customer Service

We have an award-winning warranty, exchange, and customer service team that guarantees hassle-free solutions to any issue you might have within the 24 business hours.



**Tel: +1(951)751-2590 (US ONLY)**

Monday-Friday: 9:00AM-4:30PM



**Email: [support@idooworld.com](mailto:support@idooworld.com)**

\*For defective products or the return of items, please contact us with your order number within the specified warranty period. DO NOT dispose of any product parts as they may be required for inspection/repair.



### **FCC Regulatory Compliance**

This device complies with part 15 of the FCC Rules. Operation is subject to the following two conditions:

(1) This device may not cause harmful interference, and (2) this device must accept any interference received, including interference that may cause undesired operation.

Warning: Changes or modifications not expressly approved by the party responsible for compliance could void the user's authority to operate the equipment.

Note: This equipment has been tested and found to comply with the limits for a Class B digital device, pursuant to Part 15 of the FCC Rules. These limits are designed to provide reasonable protection against harmful interference in a residential installation. This equipment generates, uses and can radiate radio frequency energy and, if not installed and used in accordance with the instructions, may cause harmful interference to radio communications. However, there is no guarantee that interference will not occur in a particular installation.

If this equipment does cause harmful interference to radio or television reception, which can be determined by turning the equipment off and on, the user is encouraged to try to correct the interference by one or more of the following measures:

- Reorient or relocate the receiving antenna.
- Increase the separation between the equipment and receiver.
- Connect the equipment into an outlet on a circuit different from that to which the receiver is connected.
- Consult the dealer or an experienced radio/TV technician for help.

### **RF Exposure Compliance**

This equipment complies with FCC radiation exposure limits set forth for an uncontrolled environment. This transmitter must not be co-located or operating in conjunction with any other antenna or transmitter.

### **ISED Regulatory compliance**

This device contains licence-exempt transmitters that comply with Innovation, Science and Economic Development Canada's licence-exempt RSS(s).

Operation is subject to the following two conditions:

(1) This device may not cause interference.

(2) This device must accept any interference, including interference that may cause undesired operation of the device.

Le présent appareil est conforme aux CNR d'Industrie Canada applicables aux appareils radio exempts de licence. L'exploitation est autorisée aux deux conditions suivantes:

(1) l'appareil ne doit pas produire de brouillage, et (2) l'utilisateur de l'appareil doit accepter tout brouillage radioélectrique subi, même si le brouillage est susceptible d'en compromettre le fonctionnement.

This equipment complies with IC RSS-102 radiation exposure limits set forth for an uncontrolled environment.

Cet équipement est conforme aux limites d'exposition aux radiations IC CNR-102 établies pour un environnement non contrôlé.





**US Importer: JOICOM CORPORATION**

14129 The Merge Street, Building 3 Unit A, Eastvale, CA 92880

**Manufacturer: Shenzhen Ruiyi Business Technology Co., Ltd.**

No. 810-C063, 8th Floor, Xiangbin International Financial  
Centre, No.18, West Free Trade Street, China Special Economic  
Zone, Qianhai Bay, Shenzhen, Guangdong Province, 518000  
China

**Made in China**

NA1

装订方式：骑马订  
尺寸:80\*80mm  
材质:128g铜版纸  
四色双面印刷